



Automelt™

Model CM24

Straight Through Conveyor Cheesemelter

Item No: _____

AIA FILE NO. / SPEC NO.

CONSULTANT/ CONTRACTOR APPROVAL



Model CM24

The Marshall **Model CM24** Conveyor Cheesemelter is ideal for melting cheese on your menu items. The unit is equipped with a variable speed conveyor control to adjust for your various products. The heat settings are pre-set so no adjustment is required. The conveyor is heavy-duty stainless steel rod for longevity. Use as a companion to Marshall's Autobroil™.

All Marshall products are supported by a nationwide service organization and in-house, full-time Customer Support Department. To place an order call:

1-800-627-8368

**ETL (US, Canada) & NSF Listed
FOR COMMERCIAL USE ONLY**

Marshall's Cheesemelter is designed specifically for fast food restaurants, sandwich shops, cafeterias, full service restaurants, snack bars and convenience stores.

FEATURES

- Plug-in motor and solid-state speed control
- Variable speed, heavy-duty drive system
- Easy to operate control panel
- Adjustable conveyor speed
- Heavy duty industrial grade heating elements

CONSTRUCTION

- Heavy gauge stainless steel
- Larger bearings give longer life
- Heavy-duty belt
- Solid weld frame construction

**Ask about Marshall's ThermoGlo™ Food Warmers, companion High Speed Toasters, and Ventilation Systems*

Marshall Air Systems, Inc.

419 Peachtree Drive South • Charlotte, North Carolina 28217 USA • Phone: (704) 525-6230 Fax: (704) 525-6229 • www.marshallair.com



Automelt™

Model CM24

Straight Through Conveyor Cheesemelter

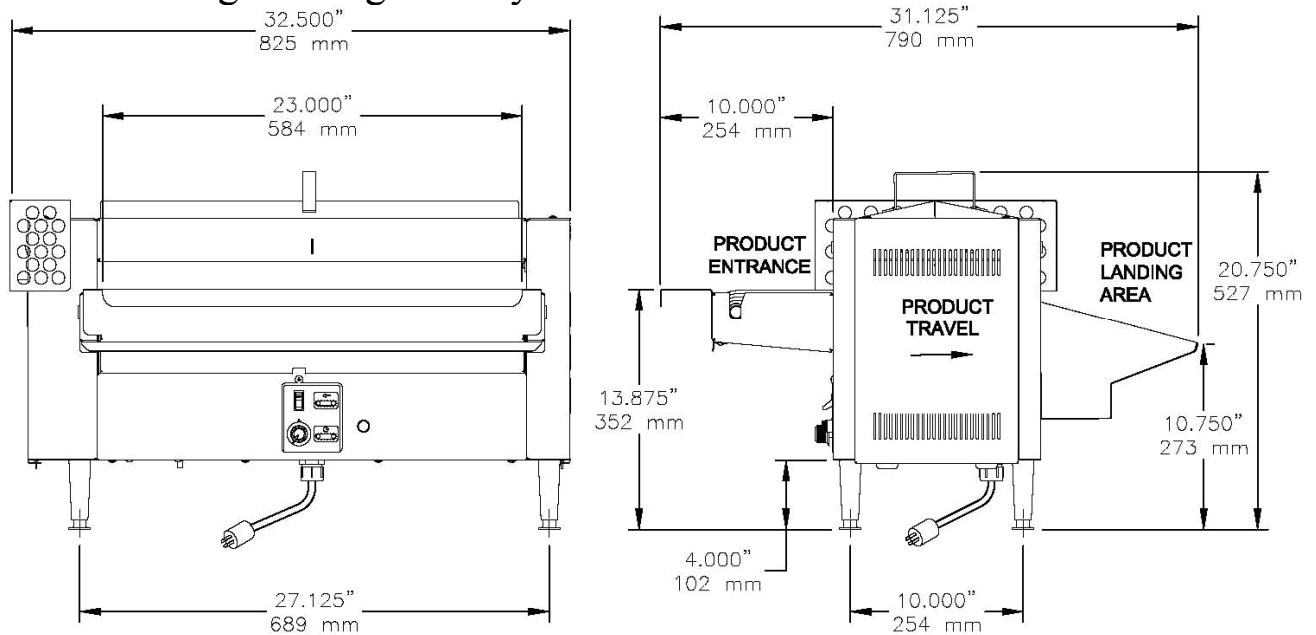

Overall Dimensions Model CM24

Dimensions:	Height: 20.750" 527mm	Width: 32.500" 825mm	Depth: 31.125" 790mm	
Shipping Information:	Weight: Net 150 lbs. 70 kilos	Ship Wt: 175 lbs. 82 kilos	Freight (USA) NMFC #63360 Class 100	Ship Cubes: 22 cubic ft. 0.64 cubic meters
Electrical Wiring:	208V/60Hz/1 ph 18.5 amps/ 3.848 kw NEMA L14-30P Plug		240V/60Hz/1 ph 21 amps/ 5.04 kw NEMA L14-30 Plug	240V/50Hz/ 1ph 21 amps/ 5.04 kw
Gas Supply:	None			
Options:	None			

Marshall Air Systems, Inc.

419 Peachtree Drive South • Charlotte, North Carolina 28217 USA • Phone: (704) 525-6230 Fax: (704) 525-6229 • www.marshallair.com